

Client
Planning and Development
City of Rochester Hills

Client Contact
Ed Ansek
248.656.4660

Giffels Webster Contact
Matthew Schwanitz
Partner

Joe Anderson, RLA, PE
LEED AP
Project Manager

Completion Date
2010

Services Provided
Landscape Architecture
Planning

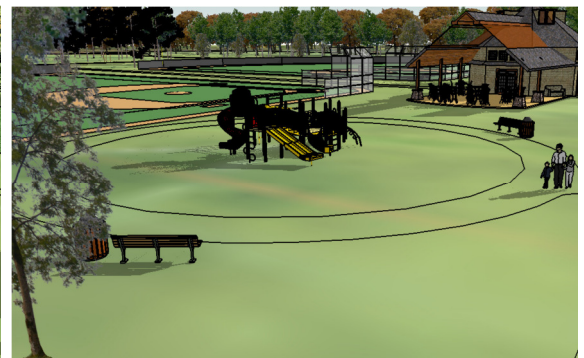
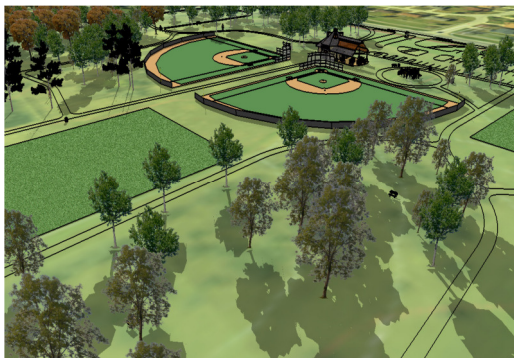

Giffels Webster was retained by the City of Rochester Hills to organize and conduct meetings with city personnel and local citizens interested in the direction the proposed development of Nowicki Park should take. These meetings generated various ideas on how the park should be developed. Our landscape architects then developed those ideas into final graphics that were reviewed by the public and city officials.

They also used their expertise in planning a graphics presentation to help guide the public and city officials to the best possible solution for what the site can accommodate and the needs of the city. An evaluation of the existing conditions and surrounding uses was done to determine the assets and limitations of the site to best determine what uses would benefit the community. A high quality final rendering of the concept plan was developed for the city to display at the city offices and on the city website.